

Light Guide for Art & Exhibitions

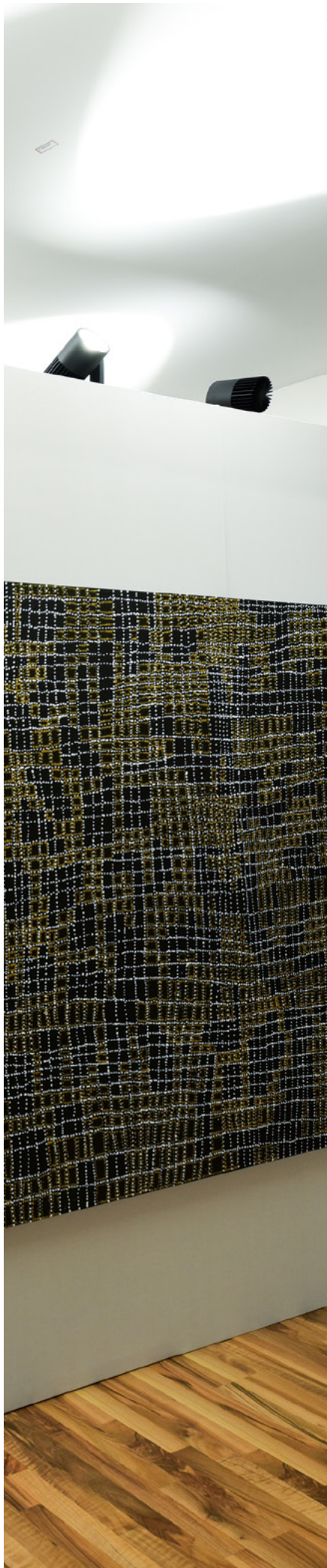



Art amazes people and arouses their emotions.

People deserve the best possible light that makes their visit to the art gallery an unforgettable experience. As museums become more interactive spaces, people start considering the visit a pleasant day out spent together with family and friends.

In terms of lighting that sets the atmosphere, from the entrance to the exit, we want to help you create the best experience for your visitors.

••• Light can influence the quality of perception towards artwork. The key is to present the exhibits with authentic colors, subtly attracting and guiding the viewer's eye. Good lighting will make visitors enjoy the masterpieces without even noticing what made them glow.



Light can reduce the energy consumption as the spotlights can now be controlled using scenarios and each luminaire can be dimmed individually. This contributes to your sustainability objectives while optimally illuminating the exhibits.



•••



•••

Light protects the precious exhibits, containing no harmful UV and IR rays that can damage the paintings in time. Even when a LED luminaire is positioned close to an object, it will deliver a gentle light that reduces the risk of color fading or sensitive materials being damaged. LEDs do not give off as much heat as conventional luminaires do, and this is important for avoiding the crack of the paintings.

•
•

Obtain maximum flexibility with a track lighting system that adapts to the unique demands of temporary exhibits and last-minute lighting design adjustments. Spotlights mounted on track can be easily moved without tools and without specialized help.

•••

A typical art gallery layout

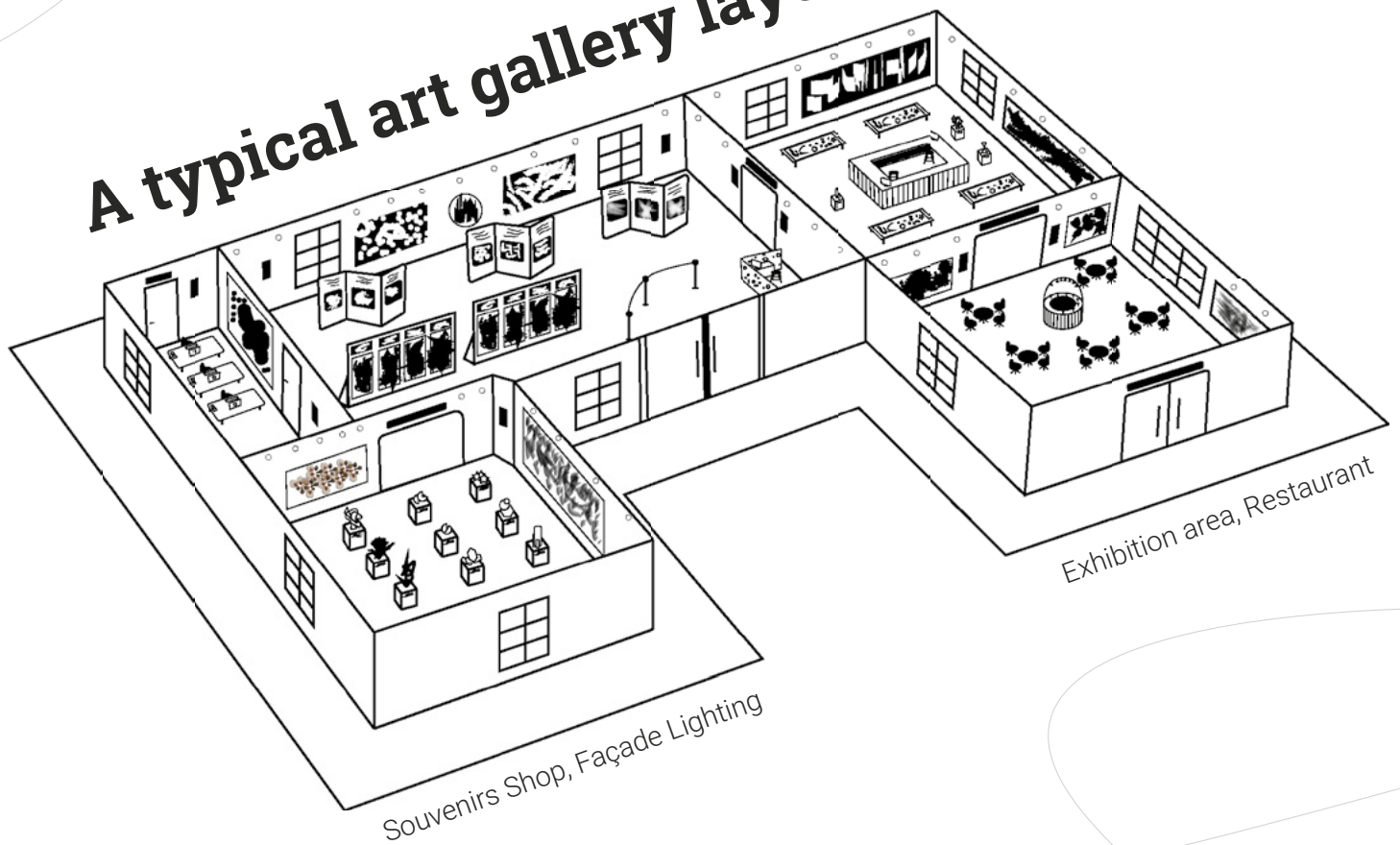

THE SCIENCE OF ART & EXHIBITIONS LIGHTING: SPECIAL COLOR TEMPERATURES FOR ARTWORK

Special color temperatures suitable for every type of art exhibit and atmosphere you want to create.

Illuminating exquisite art exhibitions that include classical pieces from the 17th century is a different task from illuminating a contemporary photography or sculpture exhibition.

Spotlights that direct light onto individual artwork are a great solution for paintings with a darker or pastel background, typical for fine art museums.

These luminaires allow the direction of the light to be adjusted, and you can ensure that the light covers most of the artwork, not just a part of it.

Many contemporary collectors prefer wall washers and recessed directional spotlights that deliver a wide distribution of light. They often create one bright wall where art is displayed and indirectly lights the entire room.

These lighting solutions provide built-in flexibility for adding, removing, or relocating art in the future; because the wall is evenly lit, you don't have to adjust a thing.

Greentek developed a range of special color temperature luminaires, each suitable for a particular type of artwork and exhibitions:

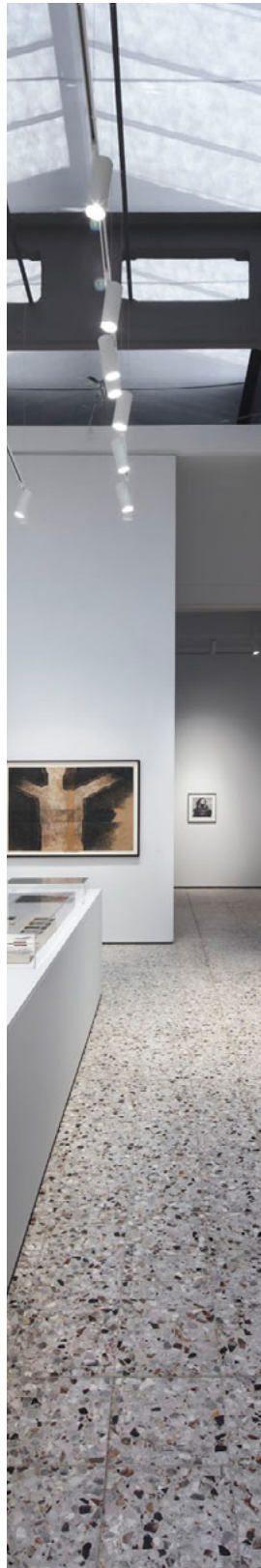
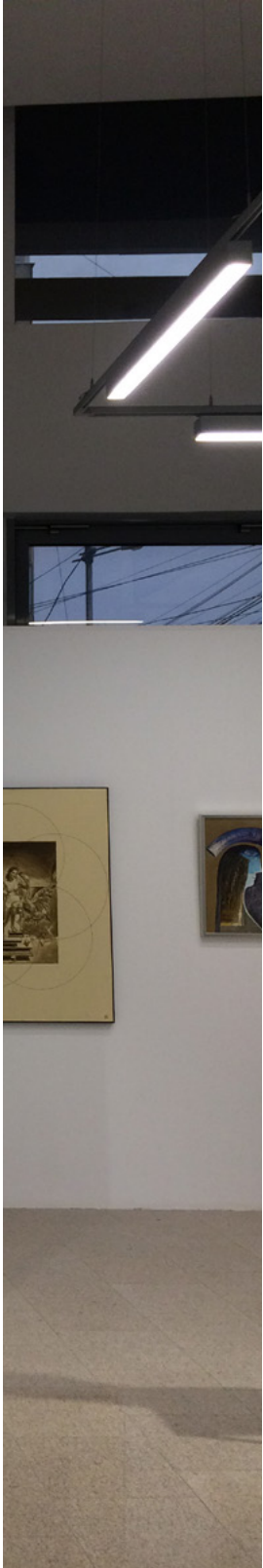

ART



ART with CRI98 enhances colors and textures, while staying true to the original shades, form and concept, with excellent color rendering. It is the result of years of research in the field of art lighting.



AGI



Taking a step further than the traditional color rendering index (CRI) – which is by definition limited to 8 colors, Greentek developed AGI, a range of colors that come much closer to how people perceive colors. GAI is a measure of hue saturation or chroma – therefore it's a better indicator of how the human eye perceives the world.

The beautiful thing about AGI light is that is suitable for a much wider range of colors, thus you can use it for highly colorful paintings and art pieces. Depending on the exhibition type, AGI is again a wonderful color to use. For exhibitions that abound in cool tones - earthy, green or blue shades - for example for contemporary photography or sculpture, AGI4000 is recommended. For exhibits that are warmer in color or multicolored (think Mondrian, Matisse or Kandinsky), AGI3000 or AGI3500 are very suitable.



TUNABLE WHITE



The spotlights incorporate tunable white LEDs, a feature that allows for the atmosphere and mood of the art gallery to be changed depending on the on the time of the day. The color temperature of the spotlight is designed to simulate daylight: a warm 2700K light in the morning gradually changes to a color temperature of 6500K as the sun peaks, then turning back to 2700K at sunset.

With a gradually changing colour, most people don't realise the subtlety of the tunable white effect directly. The gradual change results in the mood of the art gallery changing over the course of the day: it awakes with the sun in rich golden tones, achieving its peak effect at midday with a very clean natural light, and gradually returning to the early colours.



Where to start?

- **GENERAL & WALL WASHING LIGHTING**

General lighting is an essential ingredient in art galleries and exhibitions. The light should be diffuse and uniform, avoiding glare. This soft light creates little contrast and eliminates shadows. Use recessed fixtures with various beam angles to achieve the desired effect. Wall washing helps create a sense of space in the gallery, vertically delimitating rooms and contributing to a “feel-good” ambiance.

- **UP & DOWN LIGHTING**

Architectural up & down lighting can be used for a subtle general lighting or ceiling lighting that creates stunning visual effects. Stylish and practical luminaires that deliver light upwards & downwards provide a stronger contrast between general lighting and accent lighting.

- **ACCENT LIGHTING**

Accent lighting brings out the intention of the artist when it comes to artwork. It's about how you illuminate a specific art piece to show it at its best. In arts and culture, accent lighting creates the contrast required to draw attention to the specific points of interest.

Did you know that LED luminaires emit zero ultra-violet radiations?

UV light is especially damaging to art, through a process called photodegradation. The photochemical action involves a chemical change at the molecular level and is the more profound transformation resulting from the exposure to light. The most potent sources of this destructive energy come from the ultraviolet (UV) and the infrared (IR) light. And there's no UV or IR in the LED's beam.

Longevity is an important aspect in art. Having UV-free LED luminaires is crucial for museums, art collections and exhibitions that need to both preserve and present art. With a traditional luminaire, art pieces degrade quickly and lose their authenticity. It becomes important to have the best light that allows people to enjoy art generation after generation.



Exhibition area lighting

•••

Large exhibition rooms are highly demanding in terms of lighting. Diffuse light is an essential ingredient of showcasing masterpieces in their most beautiful way. Light that creates little contrast and fewer shadows is recommended. Especially for art pieces that are presented in glass boxes, the UGR level should be as low as possible to avoid the light reflection and direct glare.

Intelligent control systems can be used to make sure that brightness and light intensity are always adjusted to suit the needs of particular exhibitions. When your preset lighting scenarios, you adapt the light to different activities and events in the art gallery that demand different lighting situations.

ARTUS N TRK



Clean, elegant luminaire creates a professional and welcoming atmosphere over the info desk.



Tulip is a track mounted, adjustable accent lighting luminaire. It narrowly focuses the beam on certain displays that you want to stand out. Tulip has several accessories: BarnDoor, HoneyComb and DeepFront.



TULIP



SOLA



Tubular suspended luminaire with an interesting slim silhouette. Sola is not only geometrically interesting, its sleek design blends with a wide range of environments.

LINERA



Recessed linear solution suitable for precise accent lighting. Linera 5 is specially designed for art galleries that need to be free of a visible light source.



A modern and stylish track mounted linear luminaire. Forms a modular system for a continuous optic line. Homogenous illuminated light lines without lateral light emission.

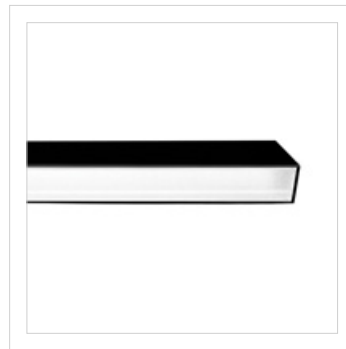

LIGHT BLADE



DYAD TRACK



One track, two different lighting effects. Mellow light delivered upwards for a pleasant atmosphere. Adjustable accent lighting delivered downwards through track-mounted spotlights and linear luminaires. The same track creates a diverse lighting experience for enhanced architectural spaces.

Souvenirs shop & restaurant lighting

Attract and make your visitors buy souvenirs for the beloved ones. To keep your visitors as much as possible in the museum's shop, it's essential to create an attractive and well-lit space. At the museum's restaurant, LED luminaires can deliver uniform, flattering light for an enjoyable atmosphere.



AMYAS TRK



If you opt for a track installation, our elegant Amyas downlights can also be mounted on the same system.

RAYLAN



This luminaire combines modern minimalist design with the finest components and the latest technology in contemporary profile lighting.



TUBE



Tube is our adjustable spotlight with a concentrated beam that creates a bright light effect. Its modern housing and directional beam enhances the architectural spaces.



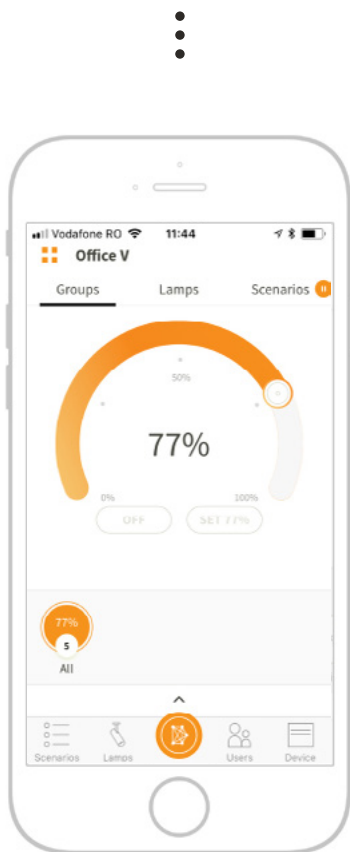

••• **DARA Lighting**

Our aim is to offer personalized, flexible, efficient and beautiful light that brings each individual comfort and the perfect lighting experience. This is why we created DARA Lighting.

DARA Lighting is a Bluetooth and Wi-Fi enabled solution that makes light control and personalization a breeze. The solution is complemented by a smartphone application that's easy to use and intuitive. Any user is able to create his own luminaire network and then create scenarios that suit his needs – depending on the day of the week, time of the day or other relevant events.

Due to its dual control – both BLE (Bluetooth Low Energy) for DALI communication and Wi-Fi, – a user can individually control an unlimited number of luminaires. With this solution any museum or art gallery has the power to tailor its lighting preferences and, at the same time, greatly reduce its energy expenses by making sure light is present only when needed.

It will become so easy to establish scenes for a vernissage and set specific lighting for certain moments of the event at certain hours.

NATURALLY REMARKABLE

Greentek Lighting is one of the few companies which fully develops products in EU, together with thorough lab testing, and offers a complete range of services to suit your every need.

So why work with us?

because:



1. Trust

We have 9+ years' experience developing innovative led lighting solutions.

2. Special Colors

Greentek is a pioneer in developing special tonal effects for retail and DIY industries, proven to enhance purchase intent.

3. Diversity

We cover all ranges of ceiling mounted and light distribution systems, special colors and other niche products.

4. Light Concept and Design

Our lighting experts analyze your lighting infrastructure and provide you the best plan to implement it, based on the latest industry requirements and trends.

5. Flexibility and Customisation

For us, business is personal. Greentek can develop or adjust luminaires according to your needs in order to create savings and value.

6. Made in EU

In order to keep high quality, Greentek luminaires are designed and manufactured in the European Union using European components.

7. Incredible Customer Care

We are in the business of customer care and we happen to create led luminaires. We take a 360° client view from technical consultancy, Intelligent Light Solutions, Project Management and site survey, to on-site implementation, product development and lab testing.

Office:

Greentek Lighting
182 A, Gh. Titeica Street
020303 2nd District, Bucharest, Romania

Tel: +40 21 230 24 64/65

Fax: +40 21 230 24 66

E-mail: office@greentek.eu

www.greentek.eu